

Tavola NG	1/8	Denominazione	RICAMBI COLONNA + COMANDO KS600	Gruppo	KS600 400V	Data	02/06	Diseg.	DNL	Dis. Ng	RI0403A2
						Data				Modifica	

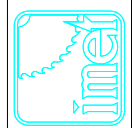



Tavola NG 3/8

Denominazione
RICAMBI BASE+MORSA
 KS600

Gruppo **KS600 400V**

Data 02/06

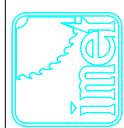
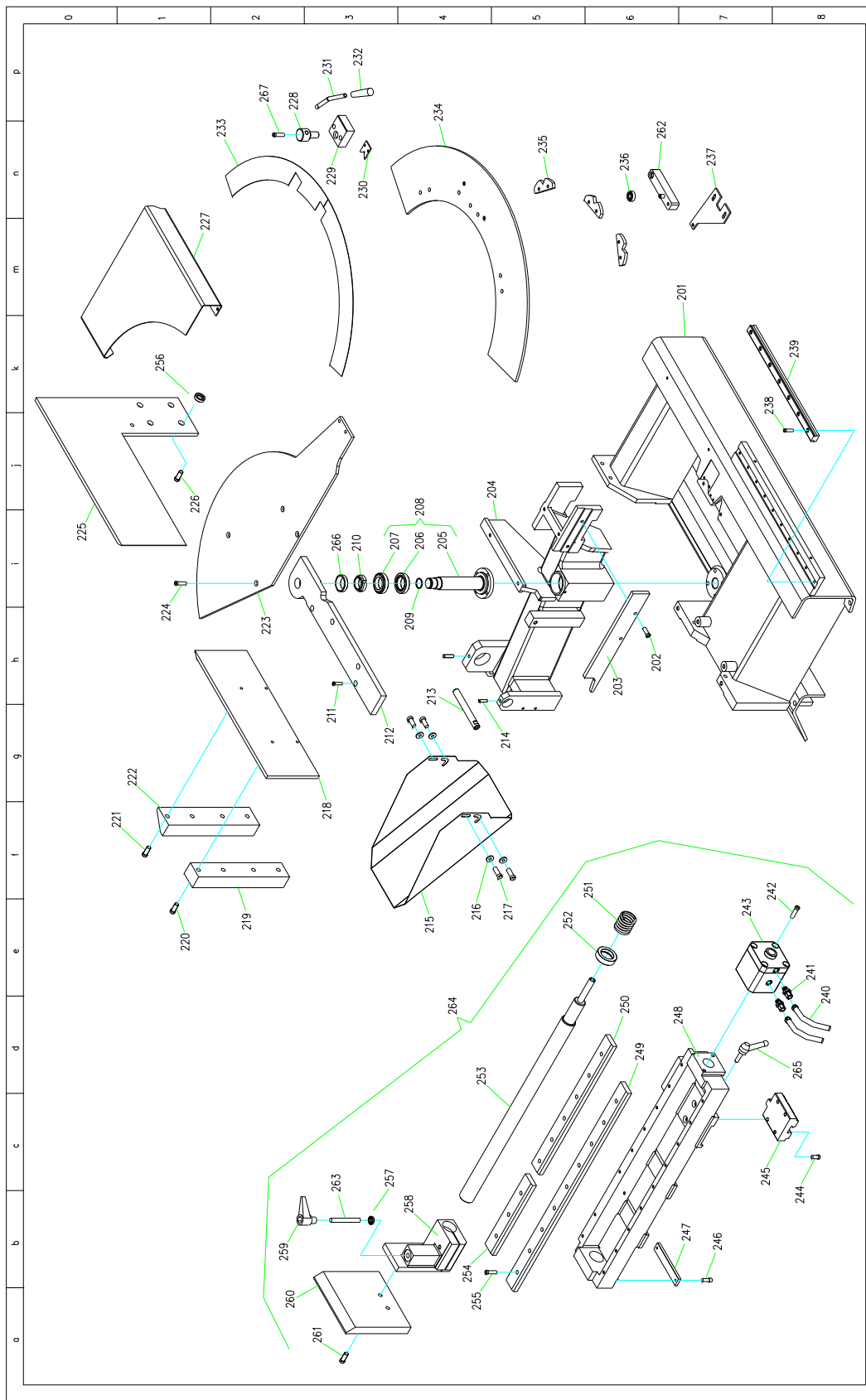
Disegn. DNL

D/Is. Ng RIO403A2

Modifica

Data

o	a	b	c	d	e	f	g	h	i	j	k	m	n	p
N°	CODICE	DESCRIZIONE	Q	N°	CODICE	DESCRIZIONE	Q	N°	CODICE	DESCRIZIONE	Q			
201	921065	IRON BASE FRAME	1	251	548865	VICE SPRING	1							
202	984300	SCREW TCE 10X25	2	252	323742	SPRING SPACER	1							
203	130912	LEFT VICE SUPPORT	1	253	140236	VICE PLATED ROD	1							
204	683046	TURNING PLATFORM	1	254	654291	HARDENED PLATE, VICE FIXED PART	1							
205	652407	TURNING PIN	1	255	977650	SCREW TCE M8X16 UNI5931	18							
206	283020	BEARING 32010X 50X80X20	1	256	744987	WASHER 12X30X4	4							
207	283020	BEARING 32010X 50X80X20	1	257	288083	AXIAL BEARING 15X28X9 51102	1							
208	0	TURNING PIN UNIT	1	258	183920	VICE TROLLEY	1							
209	119457	SEAL, OR3137 D2.62X34	1	259	536917	VICE HANDLE	1							
210	499850	SELF-LOCKING RING GP M45X1.5	1	260	486210	VICE TROLLEY JAW	1							
211	975824	SCREW TCE 14X45	4	261	974100	SCREW TCE M12X40 UNI5931	2							
212	799166	PLATFORM LOCKING KS600	1	262	528603	ANGLE LEVER	1							
213	646582	SPRING HOLDER	1	263	929364	VICE ROD M14X200/210	1							
214	946607	SCREW VCE 8X60	2	264	104912	COMPLETE HYDRAULIC VICE UNIT	1							
215	630411	REAR COOLANT PROTECTION	1	265	963557	HANDLE M10	1							
216	744045	SPECIAL WASHER D20X5	4	266	129758	SEAL 40X80X10	1							
217	977652	SCREW TCE 8X16	4	267	987110	BRASS SCREW TE 12X30	1							
218	478058	FIXED JAW	1	268										
219	851848	FIXED JAW SUPPORT, LEFT	1	269										
220	975903	SCREW TCE M16X60 UNI5931	4	270										
221	975880	SCREW TCE M16X35 UNI5931	4	271										
222	851848	FIXED JAW SUPPORT	1	272										
223	684229	RIGHT WORKTABLE	1	273										
224	965695	SCREW VSP 10X40	4	274										
225	478045	RIGHT JAW	1	275										
226	975898	SCREW TCE M16X45 UNI5931	4	276										
227	773066	RIGHT PLANE	1	277										
228	966781	LOCKING SCREW	1	278										
229	144966	ROTATION PLATE	1	279										
230	680000	O DEGREES PLATE	1	280										
231	537465	HANDLE LEVER	1	281										
232	513870	PLASTIC HANDLE	1	282										
233	911119	GRADUATED PLATE	1	283										
234	775605	ROTATION PLATE	1	284										
235	775615	ANGLE ROTATING STOP	3	285										
236	284209	BEARING 6201-2ZR 12X32X10	1	286										
237	656604	SPRING PLATE	1	287										
238	978095	SCREW TCE M8X20 UNI5931	11	288										
239	512492	LINEAR GUIDE HIWIN LGR30R760C	1	289										
240	933625	OIL TUBE R6 3/8" L.1500	2	290										
241	616230	OIL NIPPLES, BSP, 1/4" X 3/8"	2	291										
242	984229	SCREW TCE M10X110 UNI5931	2	292										
243	222755	VICE CYLINDER	1	293										
244	983893	SCREW TCE M10X25 UNI5931	4	294										
245	188035	BALLS TROLLEY HIWIN LGW30CAZ1C	1	295										
246	966470	SCREW VSP M6X16 UNI5933	2	296										
247	657015	BRASS PLATE	1	297										
248	144915	VICE BASE	1	298										
249	654279	HARDENED PLATE FOR VICE	1	299										
250	654280	HARDENED PLATE, VICE MOBIL PART	1	300										



Tavola NG 4/8

Denominazione
ELENCO RICAMBI
BASE + MORSA KS600

Gruppo

KS600 400V

Data /07/05

Disegn. DNL

Dis. Ng RI0403A2

Modifica

Data

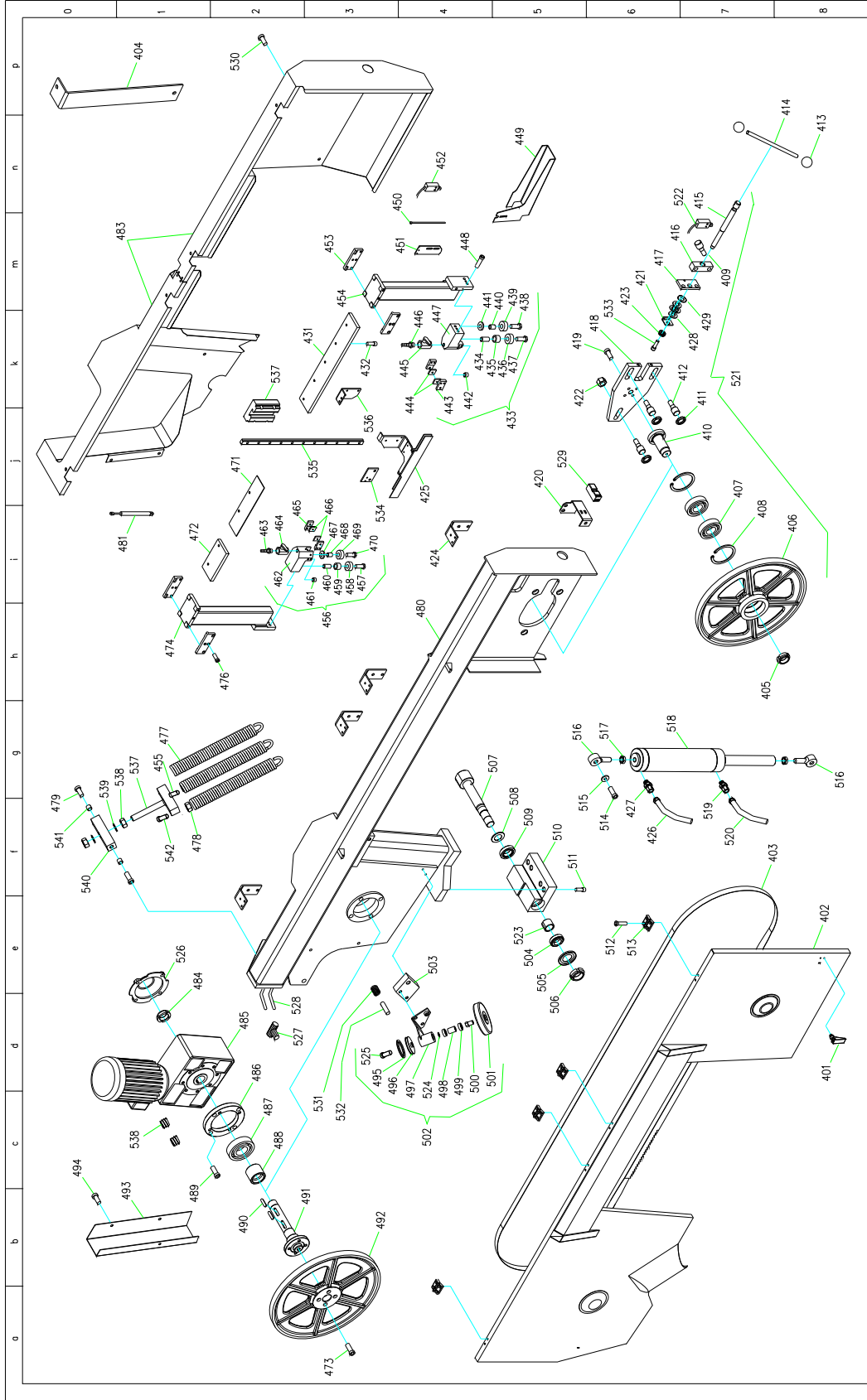

	Tavola NG 5/8	Denominazione RICAMBI ARCO KS600	Gruppo KS600 400V	Data 02/06	Disegn. DNL	Dis. Ng	R10403A2
	Modifica						

o	a	b	c	d	e	f	g	h	i	j	k	m	n	p	
N°	CODICE	DESCRIZIONE	Q	N°	CODICE	DESCRIZIONE	Q	N°	CODICE	DESCRIZIONE	Q	N°	CODICE	DESCRIZIONE	Q
401	219861	LOCKING HANDLE	2	451	673749	LOWER MICROSWITCH SUPPORT	1	501	785770	NYLON BLADE BRUSH 100X20	1				
402	201614	BAND COVER	1	492	521145	LOWER MICROSWITCH	1	502	L78570	COMPLETE BLADE BRUSH DEVICE	1				
403	614450-5/71	BLADE KS600	1	453	799157	BAND GUIDE HOLDER	4	503	998841	BLADE BRUSH PLATE	1				
404	799110	TRANSPORT BRACKET	1	454	169049	FRONT BAND GUIDE ARM	1	504	283023	TAPERED BEARING 32006X 30X55X17	1				
405	499469	SELF-LOCKING RING M30X1.5	1	455	943562	SCREW TCE 12X40	1	505	118503	METALLIC SEAL, NILOS RING	1				
406	707240	FRONT PULLEY	1	456	L31042	COMPLETE REAR BAND GUIDE	1	506	499820	SELF LOCKING RING M35X1.5	1				
407	291360	BEARING	2	457	996700	SCREW TE 8X35 UN15739	1	507	652005	PIVOTING PIN	1				
408	128229	SEGER INNER RING J100	2	458	284209	BEARING 6201 2ZR 12X32X10	1	508	118503	METALLIC SEAL, NILOS RING	1				
409	970208	SPECIAL SCREW VTCE M16X35+12X18	2	459	325603	BAND GUIDE SPACER	1	509	283067	TAPERED BEARING 32007X	1				
410	652185	FRONT PULLEY SHAFT	1	460	180043	BAND GUIDE BUSH, LONG	1	510	205507	SAW FRAME CONNECTOR	1				
411	497154	SELF-LOCKING RING KM6 M30X1.5	3	461	515780	ROLD. CARBIDE PAD D15.95X6.4	1	511	975903	SCREW TCE 16X60	4				
412	725000	FRONT PULLEY ADAPTER	3	462	631042	REAR BAND GUIDE	1	512	967245	SCREW VSP 6X25 UN15931	2				
413	513931	BALL HANDLE D.12X40=OPTIONAL	2	463	695995	TUBE HOSE P06-8	1	513	205860	HINGE ART.401-30-M6	4				
414	537249	HANDLE LEVER D.12= OPTIONAL	1	464	755801	FLOW REGULATOR ART.6310 1/8" MF	2	514	975824	SCREW TCE 14X40	2				
415	138432	BAND STRETCHER ROD	1	465	697350	SQUARE CARBIDE PAD A19.1DB10.0DC4.2 G3	2	515	738982	WASHER D.14	2				
416	219637	BAND STRETCHER LEADNUT	1	466	515860	SQUARE CARBIDE PAD A19.1DB10.0DC4.2 G3	2	516	781080	UNBALL SMG14 M14 MALE	2				
417	658322	SPRING PLATE	1	467	744550	WASHER S513X19X1.5	2	517	305000	HEX. NUT M14 UN15589	2				
418	780276	FRONT PULLEY PLATE	1	468	180050	BAND GUIDE BUSH, SHORT	1	518	222842	SAW FRAME CYLINDER	1				
419	981195	SCREW TCE 8X40	4	469	284209	BEARING 6201 2ZR 12X32X10	1	519	616230	NIPPLE 1/4 X 3/8	1				
420	673924	COVER BLADE MICROSWITCH SUPPORT	1	470	995920	SCREW TE 8X25 UN15739	1	520	933639	OIL TUBE R6 3/8" L.6400	1				
421	673924	BLADE MICROSWITCH SUPPORT	1	471	728503	BLADE PROTECTION	1	521	L07240	BAND STRETCHER COMPLETE DEVICE	1				
422	306304	SELF-LOCKING NUT M18X1.5	3	472	688809	BAND GUIDE PLATE, SHORT	1	522	520916	MICROSWITCH	1				
423	546938	CUP SPRING	19	473	973445	SCREW TCE 12X30	4	523	321680	PIVOTING PIN BUSH	1				
424	799015	COVER BLADE SUPPORT	4	474	169038	REAR BAND GUIDE ARM	1	524	128030	SEGER RING J22	1				
425	918999	FAST-DROP DEVICE 2005	1	475	0	SCREW TCE 8X16	1	525	983250	SCREW TCE 8X60 CL.8.8 UN15931	1				
426	936630	OIL TUBE 1/4" R7 L.6000 D.8	1	476	977650	SCREW TCE 8X16	4	526	180949	MOTOR SHAFT COVER	1				
427	718999	OIL ELBOW 1/4" D.8	1	477	548975	RETURN SPRING	3	527	696368	PLASTIC HOSE CONNECTOR TRS 8-12-8	1				
428	0	AXIAL BEARING 51104	3	478	864322	SPRING PLUG	3	528	956245	COOLANT TUBE 8X12	1				
429	288097	AXIAL BEARING 51104	1	479	0	SCREW TCE 12X40	2	529	520765	SAFETY SWITCH FK3393-D1	1				
430	0	BAND GUIDE PLATE, LONG	1	480	131868	SAW FRAME	1	530	970261	SPECIAL FLAT SCREW M6X10	8				
431	688814	SCREW TCE 8X16	7	481	544800	GAS SPRING 082597	2	531	547200	SPRING 12X19X2	2				
432	977650	COMPLETE FRONT BAND GUIDE	1	482	0	2 PIECES FIXED BLADE COVER	1+1	532	946607	SOCKET SCREW 8X60 UN15923	2				
433	L31042	BAND GUIDE BUSH, LONG	1	483	201603	SELF LOCKING RING M29X1.5	1	533	971895	SCREW TCE M12X20 UN15931	1				
434	180043	BAND GUIDE SPACER	1	484	499830	EL.MOTOR+ REDUCER UNIT 400V 3KW	1	534	137069	STOP FOR APPROACHING DEVICE	1				
435	325603	BEARING 6201 2ZR 12X32X10	1	485	562345	REDUCER ADAPTER	1	535	512489	HIWIN GUIDE IGR20R648C	1				
436	284209	SCREW TE 8X35 UN15739	1	486	100007	BEARING	1	536	658337	APPROACHING PLATE	1				
437	996700	SCREW TE 8X25 UN15739	1	487	291390	REDUCER SPACER	1	537	188035	HIWIN TROLLEY HGW30	1				
438	965920	BEARING 6201 2ZR 12X32X10	1	488	327184	SCREW TCE 12X40	4	538	306350	NUT M24	2				
439	284209	BAND GUIDE BUSH, SHORT	1	489	974100	SCREW TCE 12X40	4	539	738976	WASHER 45X12X5	4				
440	180050	FLAT WASHER S513X19X1.5	2	490	218783	SHAFT KEY 12X8X40 UN15931	2	540	205468	SPRING HINGE CONNECTION	1				
441	744550	ROUND CARBIDE PAD D15.95X6.4	1	491	113530	PULLEY MOTOR SHAFT	1	541	179645	SPACER 20X17X16	2				
442	515780	SIDE CARBIDE PAD SUPPORT	2	492	707222	REAR PULLEY	1	542	987105	SCREW TCE M12X30	2				
443	697350	SQUARE CARBIDE PAD A24X4 F5	1	493	728575	REAR BLADE COVER	1	543							
444	515860	FLOW REGULATOR ART.6310 1/8" MF	2	494	978095	SCREW TCE 8X20	3	544							
445	755801	TUBE HOSE P06-8	1	495	119840	ALUMINIUM WHEEL	1	545							
446	695995	FRONT BAND GUIDE	1	496	763200	BLADE BRUSH SUPPORT	1	546							
447	631042	FRONT BAND GUIDE	1	497	863140	BLADE BRUSH SPACER	1	547							
448	981195	BLADE LOWER PROTECTION	2	498	180053	BEARING 608 2ZR 8X22X7	2	548							
449	630463	LOWER MICROSWITCH CONTROL	1	499	286020	BRUSH CONNECTION	1	549							
450	138165	LOWER MICROSWITCH CONTROL	1	500	330014	BRUSH CONNECTION	1	550							

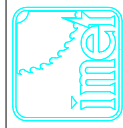

Tavola NG 6/8
Denominazione
ELENCO RICAMBI
ARCO KS600

Gruppo
KS600 400V

Data 02/06
Diseg. DNL
Dis. Ng R10403A2
Modifica